

Thermodynamic Disc Steam Trap

S 31N

Features

1. Ductile Cast Iron Body and stainless steel internals.
2. With bimetal and stopper ring for quick and efficient discharge of air and cold condensate upon start up.
3. With exchangeable seat and disc for easy maintenance.
4. Thermal insulation cover for energy conservation.
5. Inline reparability.
6. High durability.
7. For horizontal and vertical installation.

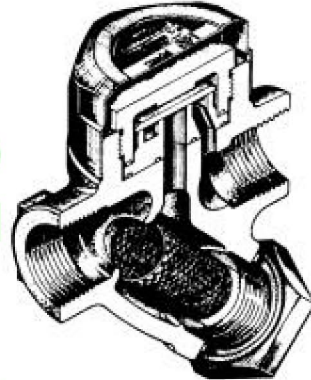

Operating Conditions & Dimensions

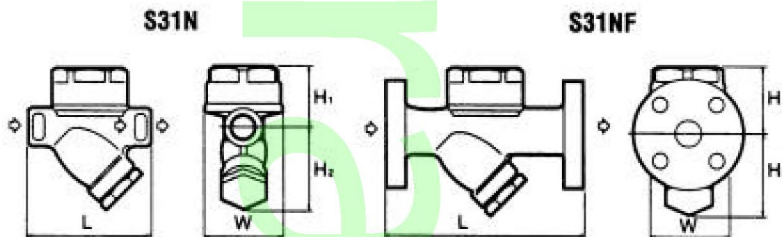

Model	Connection	Size	Operating Pressure Range		Max. Operating Temperature		Dimension mm (inch)				Weight	
			MPa	psig	°C	°F	L	H ₁	H ₂	W	kg	lb
S31N	screwed Rc, NPT	1/2"	0,03	4.4	220	428	90	55	65	60	1,1	2.4
		(3.5)					(2.2)					
		60					(2.4)					
S31NF	flanged JIS, ANSI	1/2"	1,6	230	220	428	140	55	65	60	2,5	5.5
		(5.5)					(2.2)					
		60					(2.4)					
		3/4"					150	60			3,0	6.6
		1"					160	60			4,2	9.3
							(6.3)	(2.4)				

Thermodynamic Disc Steam Trap

S 31N

Details

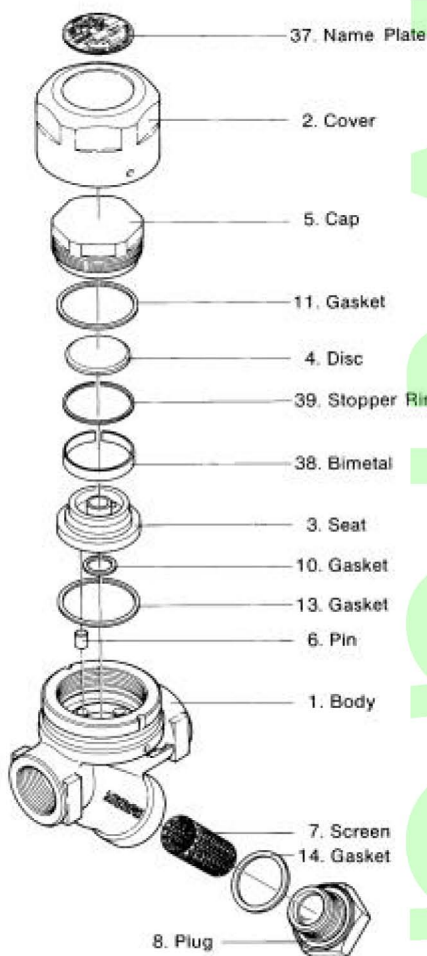

Capacity Chart

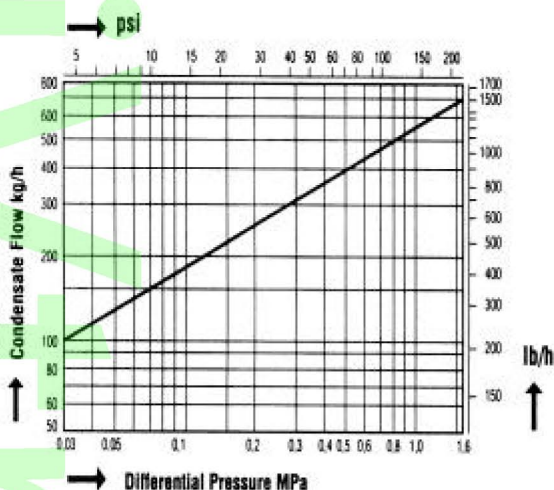

Materials

Parts-No.	Name	Material JIS/ASTM
1	Body	FCD 450
2	Cover	SUS 304
3	Seat	SUS 420J2
4	Disc	SUS 420J2
5	Cap	SUS 403
7	Screen	SUS 304
8	Plug	FCD 450
10,11 13,14	Gaskets	asbestos free
38	Bimetal	Special Alloy